



unitech  
GOLF &  
COUNTRY  
CLUB

*A life less  
ordinary*





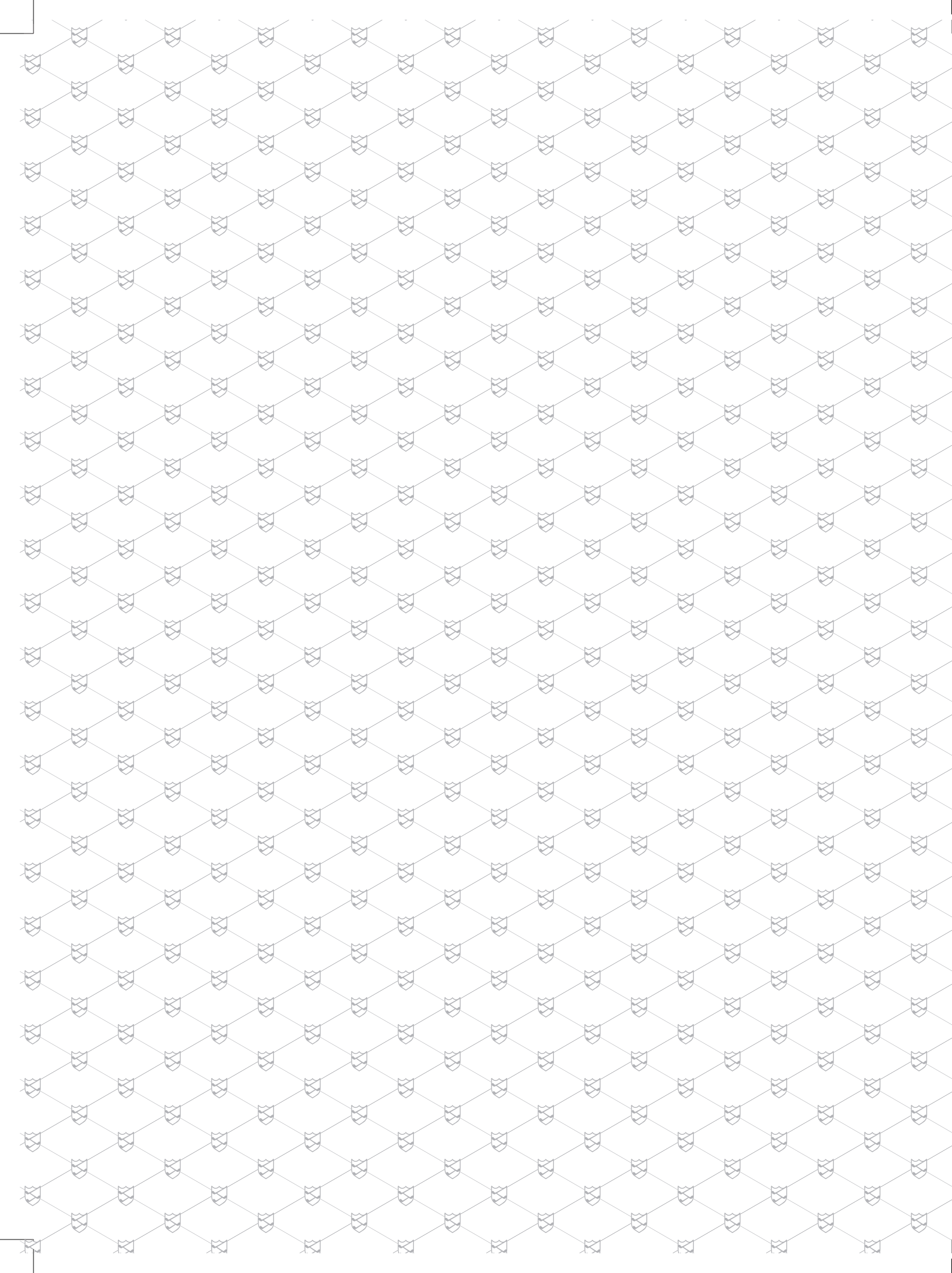

**unitech**  
**GOLF &**  
**COUNTRY**  
**CLUB**



---

*Elitism & Exclusivity is inherent*

---



---

*Command a life less ordinary*

---







Creating an unparalleled horizon of luxury in India, UGCC is a 347-acre integrated township set around a signature 9-hole golf course.

Indulge in impeccably planned exclusive golf *links* living – a resort like low density, tranquil locale in one of a kind gated residential development .

Come home to a club class lifestyle.







*Near the city, yet far from  
the maddening crowd*

- 8 mins from the nearest Metro station at Botanical Gardens, Sector 38
- 15 minutes from South Delhi via DND Expressway
- Exclusive schools in close proximity – Amity, Lotus Valley and Pathways
- 6 kms from Great India Place mall and Sector 18 market, Noida
- 10 mins from Max Hospital, Sector 19

NOIDA, Uttar Pradesh, India





---

## *The life within*

---

With every step life gets simpler !

The combination of an upscale neighbourhood with golf course, residences, serviced apartments designed to let you enjoy an unmatched way of life.

No more waking up early and hurrying your kids through breakfast to reach school. Leave behind the worries of getting stuck in traffic for your bank work. With schools, hospitals, workplaces, convenience stores and a five star hotel life, within UGCC gets finer every day.







*Explore. Indulge. Give in.*





## *Home turf*

An international standard 9 hole, 70 acre golf course designed by reputed golf designer Phil Ryan of Pacific Coast Design, Australia.

The combination of shapes, features and hazards, with the ability to position the hole in a variety of locations, varies each hole in both difficulty and strategy, ensuring your game will never be mundane.

Watch the ball sway away in the starlit sky along the wavering shadows of the fairways. With state-of-the-art floodlights, night golfing is just another aspect of club class living.

An international golf academy and development centre, coupled with cutting edge technology and curriculum, to give you the competitive edge. Equipped with a dedicated digital coaching system to provide the avid golfer a desirable experience.

*Live your game.*







## THE DECK

Unravel the treasures of nature at the floating deck, as you sip your favourite bubbly, under the azure sky. Listen to the murmur of water, creating an endless rhythm amidst the melodies of chirping birds.

A lounge, a conference room, a café, a bar – the various facets of *The Deck* unveiled.

Watch your partner tee off on the 18 hole reversible golf course as you recline and immerse in tranquility.

Let the aftertaste of calmness linger on - just a little bit longer. The perfect place to unwind, over a cup of brew with friends and family.

*An outdoor experience like never before.*







To compliment the grandeur and style of UGCC, the Deck is adorned with a lounge where you can spend either a lazy afternoon with your family or meet with clients to discuss your next big business plan.

To add to your conversations let our chefs toss up handpicked delicacies, to suit your discerning palate.





UGCC offers two architectural marvels for the connoisseurs of good living, with luxuriously designed tower lobbies and outdoor, planned walkways, jogging and cycling tracks, leisure and recreational facilities that complete the experience of *club class living*.



*Stimulating conversations begin at home.*





# Masterplan

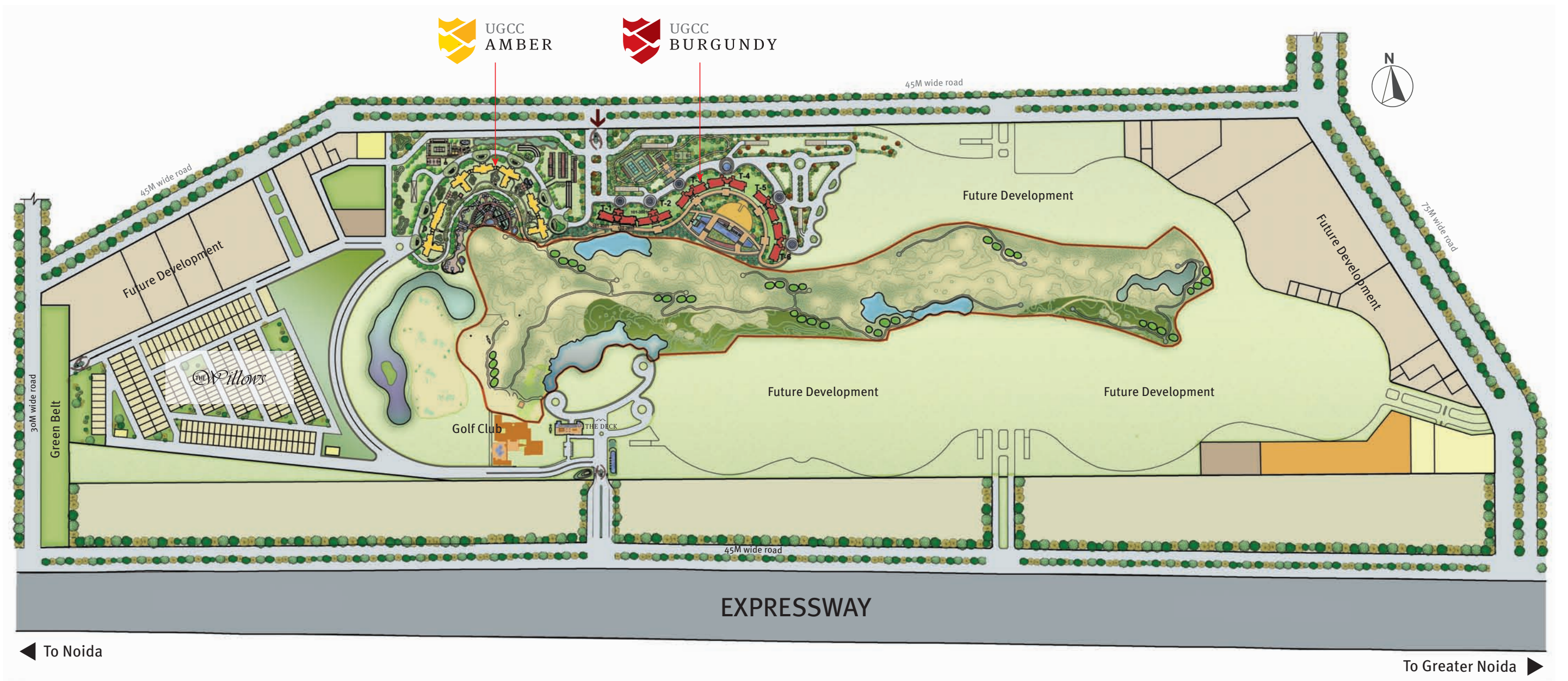





*Brilliance in itself*

7 exquisitely designed towers with panoramic views of the golf course

Entrance lobby, art, waiting lounge

Spacious living in 3 & 4 bedroom apartments in sizes ranging from 2230 – 3799 sq. ft.

A state-of-the-art clubhouse with a fully equipped gymnasium, a multi-purpose hall and more

3 large swimming pools with overhead water features, cabanas and outdoor seating





*A statement in  
ultra-luxe living*

Iconic towers up to 43 storeys high

Luxurious 4 bedroom apartments &  
penthouses in 4465 – 5575 sq. ft. sizes

Expansive views of the golf course  
from all apartments

High-speed elevators with glass façade

Exclusive sky gardens on select  
floor lobbies







*Belong to the  
magnificent clan*

PRESS





---

*Complete peace for mind, body & soul*

---

Gourmet food court Fine dining restaurant Theatre Bar & cigar lounge  
Library Indoor lap pool Modern gymnasium Yoga & aerobics studio  
Jacuzzi Sauna & spa treatment Spinning & Hydrotherapy  
Hot rock yoga Dry cleaner Bank Branch, ATM & lockers  
Private Rooms Banquet rooms Car wash





---

*Finer moments of life,  
at your beck and call*

---

Whether it's a last minute decision  
for a night out to an exclusive club  
or a dream to watch F1 live in Monte Carlo,  
all your needs would be taken care of  
by the 24x7 lifestyle concierge.

*With the services tailored-made to suit you,  
now live a luxurious life, simply!*





## *Practice not to win but to excel*

An experience never before, the sports academy would provide a carefully planned stimulating environment, to help develop an excellent foundation for creative learning and independence. UGCC will tie up with various renowned academies to create state-of-the-art indoor cricket, soccer, archery shooting and tennis facilities.



---

*Ride in with pride*

---

Stables with both pony and full bred horses – the life at UGCC, comes with an equestrian academy catering to beginners and professional riders alike.







## *Within the green acres*

As you tread through the gates, you are ushered into a world of utmost perfection. Clear blue skies above and soft greens beneath – the serene environs welcome you with open arms. The picturesque landscape adorned with various masterpieces never fails to enthrall you.

The entrance to UGCC is admirably designed as a grand plaza. The meandering green bands passing through various towers create magic and captivate you.

The road home is lined with exotic foliage and exquisite water features. Every tower entrance greets you with an especially commissioned art piece. Each phase is designed in a series of unique clusters to allow you spectacular view of the golf course.

Especially designed external spaces invite you to a relaxed sit-out around the cabanas and sparkling pools.







## *Always on-guard*

A secured environ where you can let your kids wander and let them enjoy every aspect of growing up. A piece of space which gives you complete peace of mind. Top of the line hi-tech security systems, to assure you a sound sleep.







## *Architects*

Since 1975, Callison's collaborative relationship with Nordstrom has delivered distinct shopping experiences in more than 155 new and remodeled stores. Callison's integration with Nordstrom's store planning team permits a high level of detail in every design phase, while also enabling efficient processes. Callison collaborated with the Starwood Design Group to further refine the emerging W brand and designed a modern

high-rise that reflects the personality of place and the sophistication of the W style.

Callison's innovative plan for Flatiron Crossing launched a new retail destination model, combining a two-level enclosed mall and an open-air town center. The Pearl – Qatar, a \$2.5 billion island community has won them accolades. Designed as the Riviera of the Middle East, Porto Arabia features a waterfront boardwalk with retail and restaurants, multi-family residential housing and entertainment activities.

## *Landscape Architects*

Headed by Gregory Kunak, Element Design Studio is a well established landscape design firm providing full service high quality Landscape Master Planning and Landscape Architecture services for hotels, resorts, residential developments, urban projects, mixed-use developments and golf course



landscapes throughout Asia. With a combined total of 47 years of experience in the design industry, Element is capable of providing solid design solutions for various landscape project. It claims its forte in concept design, schematic design, hardscape and softscape working drawings.





## *Lighting Design*

Bo Steiber Lighting Design, Singapore, provides specialist lighting services. The Firm has diverse experience and expertise in many part of the world from as far as the Middle East, China, South East Asia and Australia.

Their work has covered many types of applications in various fields, including hotel and resorts, residential communities, clubs and

restaurants, food courts, shopping complexes, landscape and streetscape, commercial offices, institutional buildings including school, libraries, theatres etc.

In recent years Bo Steiber has been awarded six certificates of commendation by the Illuminating Engineering Society of Australia and New Zealand for outstanding lighting design.

## *Sports Architecture*

Populous is a global design practice specialising in creating environments that draw people and communities together for unforgettable experiences.

Around the world, Populous projects include an involvement in more than 800 projects including Olympic Games, soccer and rugby clubs,



international tennis facilities such as Wimbledon for the All England Lawn Tennis & Croquet Club, as well as Major League Baseball franchises, National Football League franchises, arenas, racecourses and convention centres.





## *Signage Consultants*

Founded by Scott Cuyler and Mike Moore in 1996, Square Peg Design is an award-winning environmental graphic design firm specializing in the development of wayfinding, signing and branding programs, marketing communications and print design. With offices in California, Singapore and Dubai, their projects range from hospitality, residential,

retail, corporate, campus and entertainment venues to citywide programs.

Amongst their most prestigious projects is Burj Khalifa in Dubai wherein they designed the way finding and signing program and also coordinated the fabrication and installation for over 9,000 signs. Some of their recent accolades are SEG D Merit Award – 2009 for their work at the Dubai Mall.

## *Art Consultant*

The amalgamation of nature with sculptures is a unique combination which adorns the entrance of each tower. The masterfully crafted marble veils blend well with the picturesque landscape. The sculptures are masterfully crafted by renowned French artist Sylvestra Gauvrit. He creates beautiful marble



and steel sculptures that have been commissioned for public and private collections throughout Europe and South East Asia. The overall aesthetic appeal of UGCC is undertaken by international art consultant Sarah Pringle.





## *Unitech*

Established in 1972, Unitech is today a leading real estate developer in India. Known for the quality of its products, it is the first developer to have been certified with ISO 9001:2000 in North India and offers the most diversified product mix comprising residential, commercial/IT parks, retail, hotels, amusement parks and SEZs.

The most coveted brand was declared a 'Power Brand' in the Power Brands Mega Edition, 2011. The Company is also the recipient of the CW Architect and Builders Award, 2008 for being one of India's Top Ten Builders.

Unitech has long partnered with internationally acclaimed architects and design consultants, including SOM (USA), Maunsell AECOM (HK), MEA Systra (France), Callison Inc. (USA), FORREC (Canada), SWA and HOK (USA) for various projects.

It has an enviable clientele for commercial projects including Fidelity, McKinsey, Bank of America, Ford Motors, Nike, EDS, Hewitt, Amdocs, Ernst & Young, Reebok, Keane, Seagrams, Perfetti, Exxon Mobil and AT Kearney.





UGCC Pavillion,  
Sector 96, Expressway,  
Noida 201 305

T +91 120 3985100  
F +91 120 3985167  
W [www.ugcc-india.com](http://www.ugcc-india.com)

